

VELA

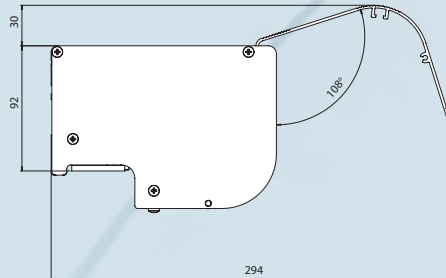

Vela è un motoriduttore elettromeccanico per porte automatiche scorrevoli max 140 kg, utilizzo semi-intensivo.

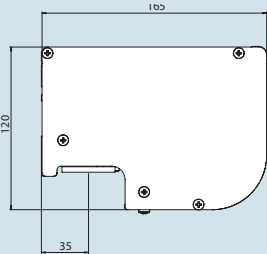
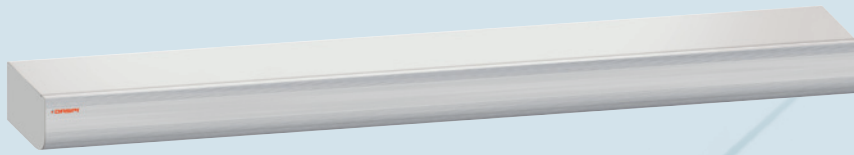

Vela is an electromechanical gear motor to open automatic sliding doors max 140 kg, semi-intensive use.



Vela es un motoreductor electromecánico para puertas automáticas corredizas de max 140 kg para uso semi-intensivo.



Vela est un opérateur électromécanique pour portes automatiques coulissantes jusqu'à 140 kg, usage semi-intensif.

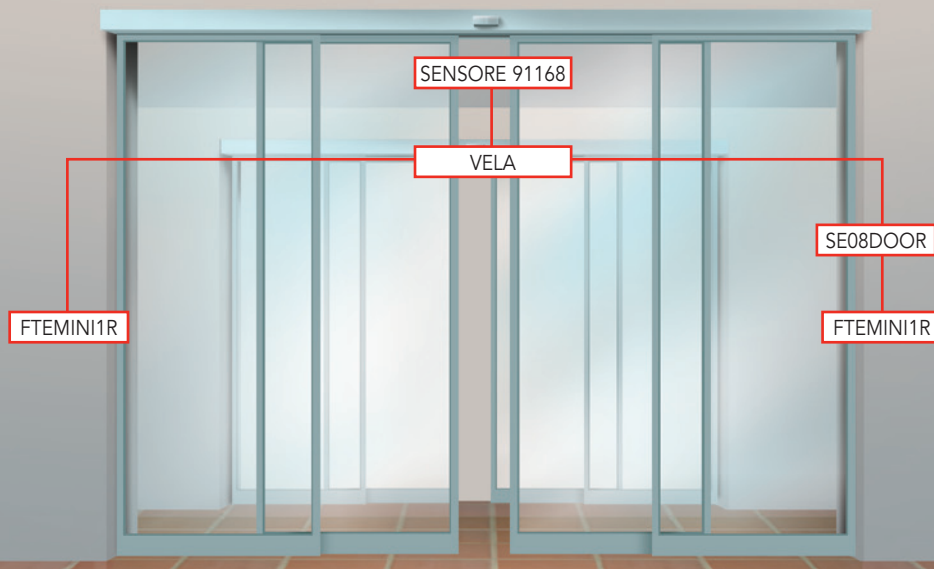

DATI TECNICI

TECHNICAL DATA

VELA

ALIMENTAZIONE	POWER SUPPLY	230 VAC +/- 10% - 50/60 Hz
CICLI	DUTY CYCLES	SEMI INTENSIVE
POTENZA	POWER	70 W
ALIMENTAZIONE PERIFERICHE	PERIPHERALS POWER SUPPLY	24 VDC - 500 mA MAX
PORTATA MASSIMA X 1 ANTA	MAXIMUM LOAD CAPACITY FOR 1 DOOR	1 ANTA / 1 LEAF = 140 KG
PORTATA MASSIMA X 2 ANTE	MAXIMUM LOAD CAPACITY FOR 2 DOORS	2 ANTE / 2 LEAVES = 70+70 KG
DIMENSIONI STANDARD VANO PASSAGGIO	STANDARD SIZE OF APERTURE	1 ANTA / 1 LEAF = 800/3000 MM
DIMENSIONI STANDARD VANO PASSAGGIO	STANDARD SIZE OF APERTURE	2 ANTE/2 LEAVES = 1000/3000 MM
VELOCITÀ DI APERTURA	OPENING SPEED	REGOLABILE FINO A/ADJUSTABLE UP TO 55 CM/SEC
VELOCITÀ IN CHIUSURA	CLOSING SPEED	REGOLABILE FINO A/ADJUSTABLE UP TO 55 CM/SEC
VELOCITÀ DI ACCOSTAMENTO IN APERTURA	OPENING APPROACH SPEED	REGOLABILE FINO A/ADJUSTABLE UP TO 10 CM/SEC
VELOCITÀ DI ACCOSTAMENTO IN CHIUSURA	CLOSING APPROACH SPEED	REGOLABILE FINO A/ADJUSTABLE UP TO 10 CM/SEC
SPAZIO DI ACCOSTAMENTO IN APERTURA	OPENING APPROACH SPACE	REGOLABILE FINO A/ADJUSTABLE UP TO 50 CM
SPAZIO DI ACCOSTAMENTO IN CHIUSURA	CLOSING APPROACH SPACE	REGOLABILE FINO A/ADJUSTABLE UP TO 50 CM
TEMPO RICHISURA AUTOMATICA	AUTOMATIC RE-CLOSING WAITING TIME	DA 0 A 60 SEC / FROM 0 TO 60 SEC
TEMPERATURA AMBIENTE DI ESERCIZIO	OPERATING TEMPERATURE RANGE	- 20°C + 50°C
ACCELERAZIONE	ACCELERATION	REGOLABILE ELETTRONICAMENTE / ELECTRONIC ADJUSTMENT
FORZA DI SPINTA	IMPULSE FORCE	REGOLABILE 100/150 N / ELECTRONIC 100/150 N
RICONOSCIMENTO OSTACOLI	OBSTACLE DETECTION	REGOLABILE ELETTRONICAMENTE / ELECTRONIC ADJUSTMENT

Cod. VELA



1 Modulo motore Vela con elettronica
+ 1 Rinvio cinghia con encoder Vela
+ 1 unità di emergenza con batteria.

1 Vela motor module with electronics
+ 1 Vela belt transmission with pulley
+ 1 emergency unit with battery.

1 Módulo motor Vela con dispositivos electrónicos
+ 1 Reenvío correa con polea Vela
+ 1 unidad de emergencia con batería.

1 Module moteur Vela avec partie électronique
+ 1 renvoi courroie avec poulie Vela
+ 1 unité d'urgence avec batterie.

VELA • PROFILE 1 DOOR

Cod. VELA2A1A



1 traversa principale estruso alluminio m 4,1 + 1 cassonetto copertura m 4,1 + 1 adattatore superiore sosp ante m 2,2 + 1 binario inferiore guida ante m 2,2 + 1 pattino plastica a pavimento + 1 coppia carrello a doppia ruota + 2 piastrina sostegno traversa + 2 tappo laterale cassonetto + 1 fermo con gommino stop anta + 1 cinghia dentata Vela 5,00 m + 1 piastra giunzione cinghia + 1 staffa trascinamento anta.

MAX OPENING
VL 2 M

1 extruded aluminium 4.1 m main crossbeam + 1 outer case 4.1 m + 1 overhead door susp. adapter 2.2 m + 1 lower door guide track 2.2 m + 1 plastic floor runner + 1 pair double wheel carriages + 2 crossbeam support plates + 2 side closures for case + 1 door stops with rubber + 1 Vela 5.00 m timing belt + 1 belt junction plate + 1 door drawing bracket.

1 travesaño principal extruido aluminio m 4,1 + 1 cajón de cobertura m 4,1 + 1 adaptador superior suspensión puertas m 2,2 + 1 riel inferior de guía hojas m 2,2 + 1 patín de plástico en el suelo + 1 par de carros de doble rueda + 2 placas de soporte del travesaño + 2 tapones laterales del cajón + 1 topes con goma de parada de la puerta + 1 correa dentada Vela 5,00 m + 1 placa de junta correa + 1 estribo de arrastramiento puerta.

1 traverse principale aluminium extrudé 4,1 m + 1 caisson couverture 4,1 m + 1 adaptateur supérieur susp. vantaux 2,2 m + 1 rail inférieur guidage vantaux 2,2 m + 1 bande plastique au sol + 1 paire chariots à double roue + 2 platines support traverse + 2 couvercles latéraux caisson + 1 butées avec caoutchouc stop vantail + 1 courroie dentée Vela 5,00 m + 1 plaque jonction courroie + 1 bride entraînement vantail.

Cod. VELA3A1A



1 traversa principale estruso alluminio m 6,1 + 1 cassonetto copertura m 6,1 + 1 adattatore superiore sosp ante m 3,4 + 1 binario inferiore guida ante m 3,4 + 1 pattino plastica a pavimento + 1 coppia carrello a doppia ruota + 2 piastrina sostegno traversa + 2 tappo laterale cassonetto + 1 fermo con gommino stop anta + 1 cinghia dentata Vela 7 m + 1 piastra giunzione cinghia + 1 staffa trascinamento anta.

MAX OPENING
VL 3 M

1 extruded aluminium 6.1 m main crossbeam + 1 outer case 6.1 m + 1 overhead door susp. adapter 3.4 m + 1 lower door guide track 3.4 m + 1 plastic floor runner + 1 pair double wheel carriages + 2 crossbeam support plates + 2 side closures for case + 1 door stops with rubber + 1 Vela 7 m timing belt + 1 belt junction plate + 1 door drawing bracket.

1 travesaño principal extruido aluminio m 6,1 + 1 cajón de cobertura m 6,1 + 1 adaptador superior suspensión puertas m 3,4 + 1 riel inferior de guía hojas m 3,4 + 1 patín de plástico en el suelo + 1 par de carros de doble rueda + 2 placas de soporte del travesaño + 2 tapones laterales del cajón + 1 topes con goma de parada de la puerta + 1 correa dentada Vela 7 m + 1 placa de junta correa + 1 estribo de arrastramiento puerta.

1 traverse principale aluminium extrudé 6,1 m + 1 caisson couverture 6,1 m + 1 adaptateur supérieur susp. vantaux 3,4 m + 1 rail inférieur guidage vantaux 3,4 m + 1 bande plastique au sol + 1 paire chariots à double roue + 2 platines support traverse + 2 couvercles latéraux caisson + 1 butées avec caoutchouc stop vantail + 1 courroie dentée Vela 7 m + 1 plaque jonction courroie + 1 bride entraînement vantail.

VELA • PROFILE 2 DOORS

Cod. **VELA2A2A**



MAX OPENING
VL 2 M

 1 traversa principale estruso alluminio m 4,1 + 1 cassonetto copertura m 4,1 + 1 adattatore superiore sosp ante m 2,2 + 1 binario inferiore guida ante m 2,2 + 2 pattino plastica a pavimento + 2 coppia carrello a doppia ruota + 2 piastrina sostegno traversa + 2 tappo laterale cassonetto + 2 fermo con gommino stop anta + 1 cinghia dentata Vela 5,00 m + 2 piastre giunzione cinghia + 2 staffa trascinamento anta.

 1 extruded aluminium 4.1 m main crossbeam + 1 outer case 4.1 m + 1 overhead door susp. adapter 2.2 m + 1 lower door guide track 2.2 m + 2 plastic floor runners + 2 pairs double wheel carriages + 2 crossbeam support plates + 2 side closures for case + 2 door stops with rubber + 1 Vela 5.00 m timing belt + 2 belt junction plates + 2 door drawing bracket.

 1 travesaño principal extruido aluminio m 4,1 + 1 cajón de cobertura m 4,1 + 1 adaptador superior suspensión puertas m 2,2 + 1 riel inferior de guía hojas m 2,2 + 2 patines de plástico en el suelo + 2 pares carro de doble rueda + 2 placas de soporte del travesaño + 2 tapones laterales del cajón + 2 topes con goma de parada de la puerta + 1 correa dentada Vela 5,00 m + 2 placas de junta correa + 2 estribos de arrastramiento puerta.

 1 traverse principale aluminium extrudé 4,1 m + 1 caisson couverture 4,1 m + 1 adaptateur supérieur susp. vantaux 2,2 m + 1 rail inférieur guidage vantaux 2,2 m + 2 bandes plastiques au sol + 2 paires chariots à double roue + 2 platines support traverse + 2 couvercles latéraux caisson + 2 butées avec caoutchouc stop vantail + 1 courroie dentée Vela 5,00 m + 2 plaques jonction courroie + 2 brides entraînement vantail.

Cod. **VELA2A2A**



MAX OPENING
VL 3 M

 1 traversa principale estruso alluminio m 6,1 + 1 cassonetto copertura m 6,1 + 1 adattatore superiore sosp ante m 3,4 + 1 binario inferiore guida ante m 3,4 + 2 pattino plastica a pavimento + 2 coppia carrello a doppia ruota + 2 piastrina sostegno traversa + 2 tappo laterale cassonetto + 2 fermo con gommino stop anta + 1 cinghia dentata Vela 7 m + 2 piastre giunzione cinghia + 2 staffa trascinamento anta.

 1 extruded aluminium 6.1 m main crossbeam + 1 outer case 6.1 m, + 1 overhead door susp. adapter 3.4 m, + 1 lower door guide track 3.4 m + 2 plastic floor runners + 2 pairs double wheel carriage + 2 crossbeam support plates + 2 side closures for case + 2 door stops with rubber + 1 Vela 7 m timing belt + 2 belt junction plates + 2 door drawing bracket.

 1 travesaño principal extruido aluminio m 6,1 + 1 cajón de cobertura m 6,1 + 1 adaptador superior suspensión puertas m 3,4 + 1 riel inferior de guía hojas m 3,4 + 2 patines de plástico en el suelo + 2 pares de carros de doble rueda + 2 placas de soporte del travesaño + 2 tapones laterales del cajón + 2 topes con goma de parada de la puerta + 1 correa dentada Vela 7 m + 2 placas de junta correa + 2 estribos de arrastramiento puerta.

 1 traverse principale aluminium extrudé 6,1 m + 1 caisson couverture 6,1 m + 1 adaptateur supérieur susp. vantaux 3,4 m + 1 rail inférieur guidage vantaux 3,4 m + 2 bandes plastiques au sol + 2 paires chariots à double roue + 2 platines support traverse + 2 couvercles latéraux caisson + 2 butées avec caoutchouc stop vantail + 1 courroie dentée Vela 7 m + 2 plaques jonction courroie + 2 brides entraînement vantail.